



More Water More Profit



An ISO 9001:2008 Company

## PRODUCT COLLECTION



### CAPTAIN PUMPS PVT. LTD.

#### Head Office & Works :

Nr. Gathamani Patiya, Ahmedabad Highway, Palanpur-385001  
Dist : Banaskantha, N.Gujarat, India.  
Phone : +91 2742-265974, Fax : +91 2742 - 265975

#### Corporate Office :

1<sup>st</sup> Floor, 113, Sayona Center, Memco Char Rasta, Naroda Road, Ahmedabad, Gujarat  
Phone : +91 79-22202255

Website : [www.captionpumps.com](http://www.captionpumps.com) | E-mail : [info@captionpumps.com](mailto:info@captionpumps.com)







## About Us

Water, food and air, is most importance in everyone's life. As we all know that India is an Agricultural Country hence water is also important for agriculture. Captain Pumps Private Limited is working in this field since 15 years and provides simply solution to get water.

Captain Pumps Pvt. Ltd is one of India's pioneer manufacturers and exporter of submersible pump and motor, with more than a decade of market leadership behind it. The plant is located in India's Industrial hub - Gujarat at Palanpur and it is situated at 130 km from Ahmedabad on Ahmedabad-Delhi highway. Captain Pumps Pvt. Ltd certified by ISI (Bureau of Indian Standards), ISO and STAR RATING (Bureau of Energy efficiency) Pump sets.





## We Are

The group of Caption started its journey since 2000, under the leadership of **Mr. Ambalal Patel**. Now we seen that the Captain Pumps is most leading company in India and the Caption Brand pump sets are most popular household name across India's Rural, Urban and Industrial sector since 2000.

## Vision

To become a leading player in the field of agriculture sector with our submersible product. Our strong point is "Quality", "Service", "Reliability", "Commitment" and "Management". We work with Relationship and providing high quality Product yield through optimum utilization of available terming resources.

## Mission

We will develop design of innovative product such as oil field, industrial pumps & submersible pumps. We shall expand the current distributor's network worldwide by appointing direct country wide partners. We will work for maximum ISI model products in India and in 2015 especially will have superior technology products with highest models.

## Quality Policy

We Caption Pumps Pvt. Ltd carry out manufacturing of submersible pump sets and open well Monosets. We are committed to enhance customer satisfaction by meeting customer requirements & expectations, supplying quality product on scheduled time and continually improve the effectiveness of the quality management system.

*More Water... More Profit...*





**3"**

## Submersible Pumpsets

**3R**

Water Field

Suitable for 75 mm Borewell

HP / kw Rating	0.5 to 1.5 HP / 0.38 to 1.13 kw
Discharge Range	Upto 96 lpm
Head Range	upto 120 Mtrs.

### Application



Domestic | Gardens | Dairies | Industries | Hotels | Hospitals



**5"**

## Submersible Pumpsets

**5M, 5E** (5" Motor with 6" Pump)

Water Field

Suitable for 125 mm Borewell

HP / kw Rating	4.0 to 15 HP / 3 to 11.3 kw
Discharge Range	Upto 1600 lpm
Head Range	upto 125 Mtrs.

### Application



Gardens | Industries | Hotels | Hospitals | Agriculture  
Civil Construction



## Submersible Pumpsets

**4R, 4M**

Suitable for 100 mm Borewell

**4"**

Water Field

HP / kw Rating	0.5 to 5.0 HP / 0.38 to 3.75 kw
Discharge Range	Upto 360 lpm
Head Range	upto 325 Mtrs.

### Application



Domestic | Gardens | Dairies | Industries | Hotels | Hospitals,  
Irrigation



## Submersible Pumpsets

**6M, 6R** (C.I. & S.S.)

Suitable for 150 mm Borewell

**6"**

Water Field

HP / kw Rating	3.0 to 30.0 HP / 2.3 to 22.3 kw
Discharge Range	Upto 1600 lpm
Head Range	upto 388 Mtrs.

Also available Single Phase

### Application



Agriculture | Industries | Hotels | Hospitals  
Suitable for Sprinkler | Fire Fighting System





**7"**

Water Field

## Submersible Pumpsets

**7M**

Suitable for 175 mm Borewell

HP / kw Rating	5.0 to 30.0 HP / 3.8 to 22.3 kw
Discharge Range	Upto 2100 lpm
Head Range	upto 178 Mtrs.

### Application



Agriculture | Industries | Hotels | Hospitals  
Civil Construction



**8"**

Water Field

## Submersible Pumpsets

**8E (6" Motor with 8" Pump)**

Suitable for 200 mm Borewell

HP / kw Rating	5.0 to 30.0 HP / 3.8 to 22.3 kw
Discharge Range	Upto 2500 lpm
Head Range	upto 126 Mtrs.

### Application



Agriculture | Industries | Hotels | Hospitals | Irrigation  
Civil Construction | Fire Fighting System



## Submersible Pumpsets

**8M**

Suitable for 200 mm Borewell

HP / kw Rating	7.5 to 85.0 HP / 5.6 to 63.4 kw
Discharge Range	Upto 3500 lpm
Head Range	upto 320 Mtrs.

### Application



Agriculture | Industries | Hotels | Hospitals | Irrigation  
Civil Construction | Fire Fighting System



## Submersible Pumpsets

**8R**

Suitable for 200 mm Borewell

HP / kw Rating	10.0 to 75.0 HP / 7.5 to 56.3 kw
Discharge Range	Upto 2000 lpm
Head Range	upto 370 Mtrs.

### Application



Agriculture | Industries | Hotels | Hospitals | Irrigation  
Civil Construction | Fire Fighting System





**9"**

Water Field

## Submersible Pumpsets

**9M**

Suitable for 250 mm Borewell

HP / kw Rating	75.0 to 125.0 HP / 56.3 to 93.4 kw
Discharge Range	Upto 3500 lpm
Head Range	upto 320 Mtrs.

### Application



Agriculture | Industries | Hotels | Hospitals | Irrigation  
Civil Construction | Fire Fighting System

## Self Priming & Monoset Pump

Water Field

### PARTICULARS

HP / kw Rating  
Discharge Range  
Head Range  
Phase

### SELF PRIMING PUMP

0.5 to 1.0 HP / 0.38 to 0.75 kw  
Upto 50 lpm  
upto 45 Mtrs.  
Single Phase

### MONOSET PUMP

0.5 to 10.0 HP / 0.38 to 7.5 kw  
Upto 1750 lpm  
upto 60 Mtrs.  
Single Phase / Three Phase

### Application



Garden | Residential Bungalow | Hotel | Hospital | Irrigation

## PUMP & MOTOR CONSTRUCTION

### PUMP

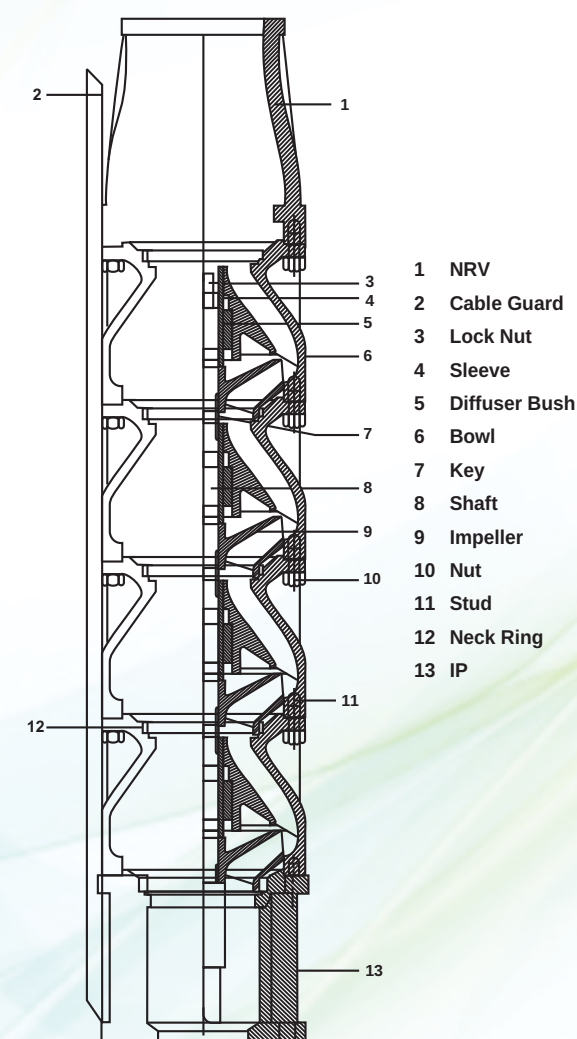

- 1 NRV
- 2 Cable Guard
- 3 Lock Nut
- 4 Sleeve
- 5 Diffuser Bush
- 6 Bowl
- 7 Key
- 8 Shaft
- 9 Impeller
- 10 Nut
- 11 Stud
- 12 Neck Ring
- 13 IP

### MOTOR

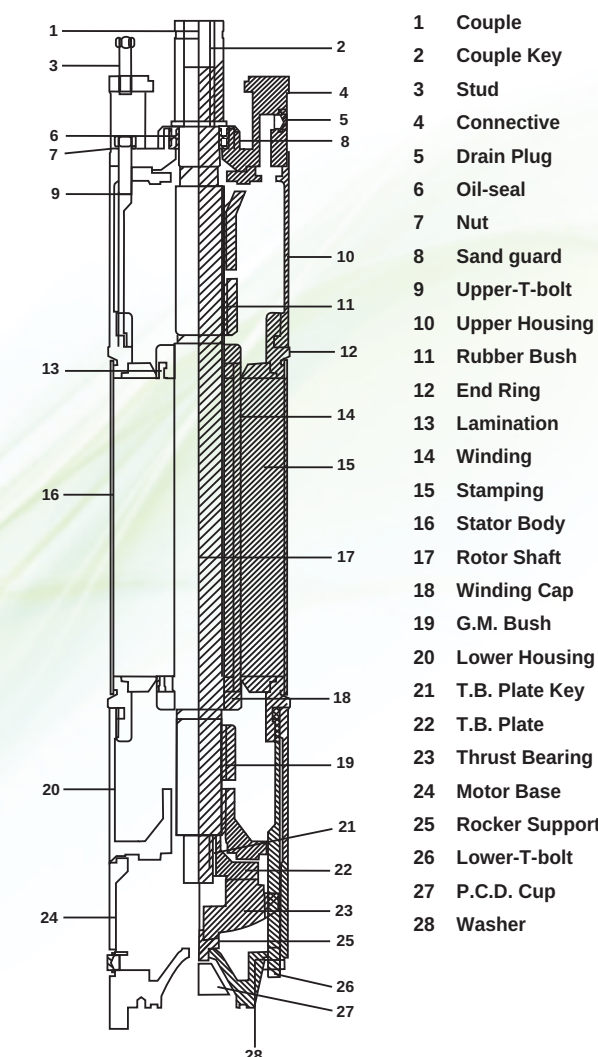

- 1 Couple
- 2 Couple Key
- 3 Stud
- 4 Connective
- 5 Drain Plug
- 6 Oil-seal
- 7 Nut
- 8 Sand guard
- 9 Upper-T-bolt
- 10 Upper Housing
- 11 Rubber Bush
- 12 End Ring
- 13 Lamination
- 14 Winding
- 15 Stamping
- 16 Stator Body
- 17 Rotor Shaft
- 18 Winding Cap
- 19 G.M. Bush
- 20 Lower Housing
- 21 T.B. Plate Key
- 22 T.B. Plate
- 23 Thrust Bearing
- 24 Motor Base
- 25 Rocker Support
- 26 Lower-T-bolt
- 27 P.C.D. Cup
- 28 Washer

## MATERIAL STRENGTH

Stamping	: C R NO.
Bowl	: FG 210
Impeller	: AISI 410
Motor Shaft / Pump Shaft	: AISI 410
Bearing Bush	: LTB4 (2% Ni.)
Stator Body	: AISI 202 (2% Ni.)
Thrust Bearing	: Carbon / AISI 420

